

Children's Torah Portion



מְצֹרָע

M'tzora
(Infected one)



H
O
T
4
T
O
R
A
H

If you will remember from last week, Tzara'at is something similar to leprosy, but we do not know exactly what it was. Even walls could get tzara'at. If a Kohen looked at the walls of a house and there were green or red spots, deeper than the surface on the wall, the house would be contaminated. The bricks and mortar with the tzara'at had to be removed and new ones put in place.

If the tzara'at returned, the house would have to be demolished, but if it didn't the house would be purified, and wouldn't have to be destroyed.

מְצֹרָע

M'tzora

M'tzora

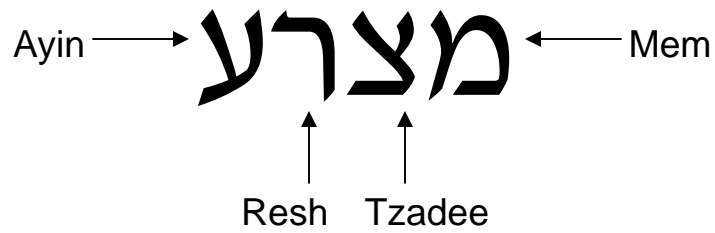

You try writing it!

מ	Cut out the cards, mix them up, then try to put them in the proper order without looking at this page.	
ע	ר	צ



Aleph-Bet Sudoku

The instructions are on page four.

		ב	ד
ג	ב		

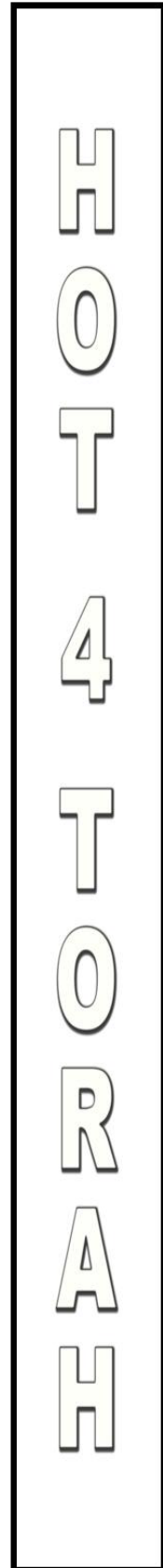

Draw a picture for the next torah portion and send it to: chayili@onetorahforall.org.

The pictures will appear in the children's parsha for that week. Please try to send them on the first or second days of the week.

The next parsha will be:
Vayiqra (Leviticus) 16:1-18:30

Rules for Aleph-Bet Sudoku

Your goal is to fill in every column, row, and grid with each of the first four characters of the aleph-bet. (אבגד)

When correctly filled in, each column, each row, and

each grid will only have one of each of the four characters.

Columns are the rows going down.

Rows are the ones going across.

Grids are the large, dark squares consisting of four smaller squares.

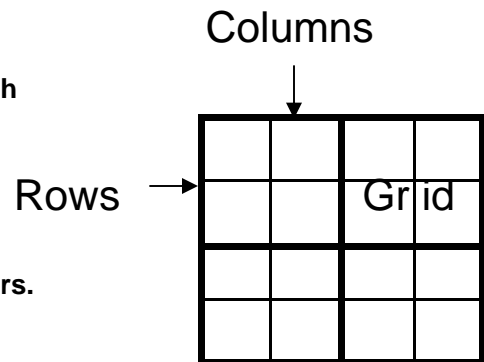

Hot 4 Torah

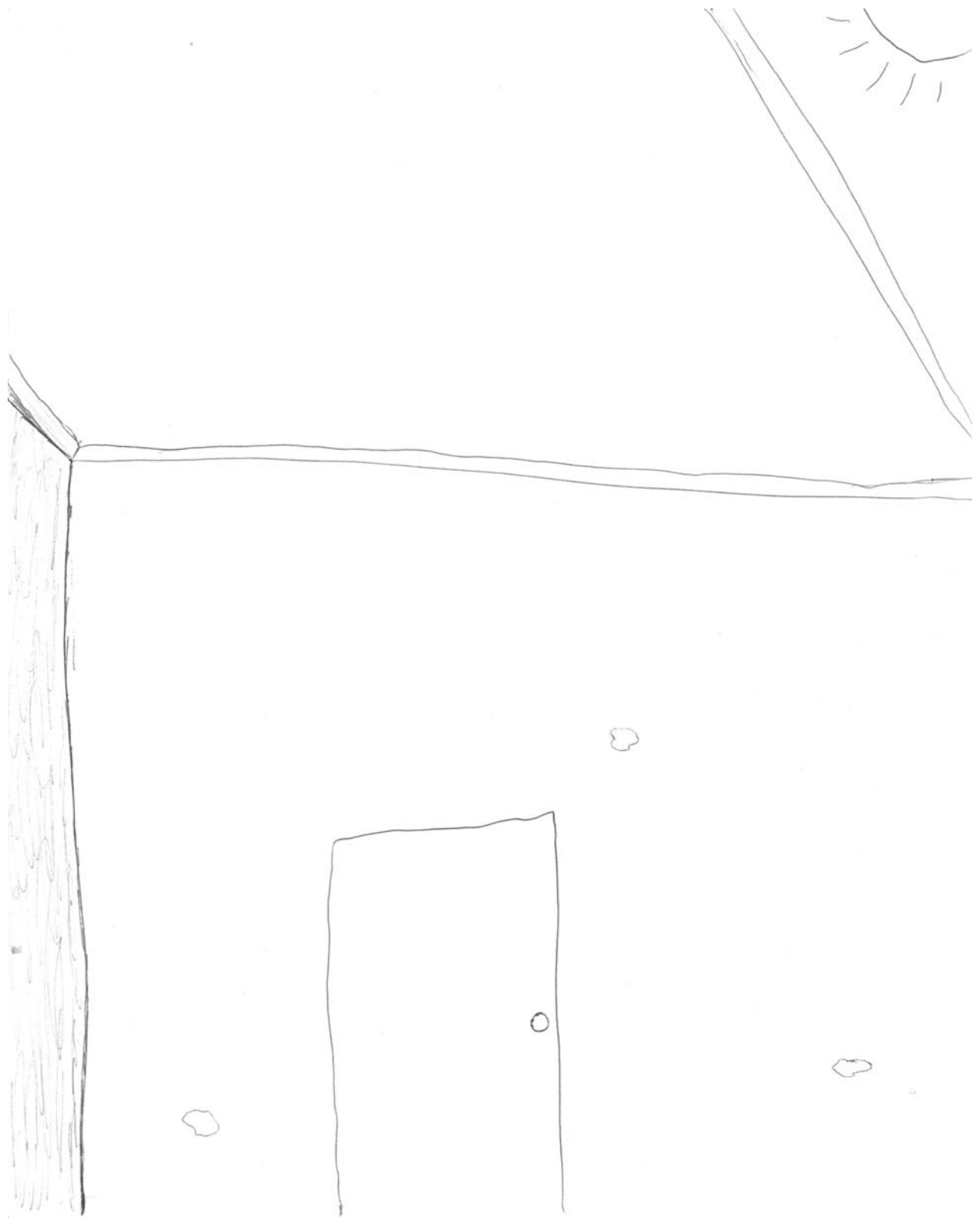

Tzara'at on a house